

# STARLAKE

*Apartment*

*Our Values, Your Class*

The first luxury apartment complex in Tay Ho Tay New Urban Area



## STARLAKE

### *A world-class urban town*

As the largest and newest urban area right in the centre of Hanoi, Starlake covers an area of 186.3 hectares, connected to the green spaces at West Lake and the main road to Noi Bai International Airport. The township is a carefully planned community based on the experience and concept of reputable developer Daewoo E&C, which balances development with a wholehearted respect for the environment.

Starlake provides a complete lifestyle that has not been available in Hanoi before: beautiful, modern homes in which to raise happy families; diverse community areas where friends and neighbours can meet; modern office buildings as well as education, hospitality, and commercial centres; and a magical landscape of sparkling lakes and green parks.





**Live the exclusive and luxury lifestyle**

Located within the Starlake urban area, Starlake Apartment is comprised of 603 premium apartment units spread across three 24-storey towers. Taking inspiration from the world-renowned South Korean style as well as from Vietnamese culture, the elegant apartments of Starlake Apartment offer homeowners an idyllic, yet modern lifestyle in a picturesque setting. This is a perfect place for living, working, playing, and learning in Hanoi, where modernity harmonises with tranquillity.





## At the heart of it all

The Starlake development is strategically connected to West Lake - considered a prime gathering place and a perfect area to live. It's just a five-minute walk from Hoang Quoc Viet Street and a 10-minute walk from the lake itself. The modern infrastructure offers easy access to Noi Bai International Airport (25 minutes) and the central business district (20 minutes).

Close to the new National Administrative Centre, to which the government plans to relocate eight ministries and government agencies, and the luxurious Starlake Villas, and many enticing recreation spots, Starlake Apartment is without question the most desirable place for residents looking for a new home that offers the highest luxury.





## Unmatched convenience

Surrounded by exciting recreational facilities amidst lush greenery, residents are transported to a world of comfort and tranquillity. Live, learn, work, and play, all in one place. Update your wardrobe, satisfy your palate, relax, and be entertained in Hanoi's largest South Korean-style urban project.

Create memories at Starlake Apartment by entertaining friends at the BBQ pavilions or keep fit at the fitness centres. Challenge the family to a game of football or tennis. Starlake is designed for you to indulge in a comprehensive range of facilities, all right at your doorstep.



\* The images in this brochure are not representation of fact.



When summer comes, take a dip at a pool while your children splash away at the children's pool. Running or cycling under the cool and lush greenery will make you feel closer to nature.

When night falls, enjoy a romantic candle-lit dinner, with luxury restaurants just a stone's throw away. Or enjoy the evening with friends around a nearby lake, with performances involving light, music, and water.



\* The images in this brochure are not representation of fact.



## High investment returns

Ownership of a Starlake Apartment entitles you to enjoy the exclusive investment opportunities with excellent returns and the potential to reap benefits from an asset that will appreciate in value in the near future, as it is the latest urban area located in four urban districts with a synchronous, modern, and completed plan.

The potential value of rents is a major strength of Starlake, as the project lies amidst a gathering of administrative, cultural, and economic activities, with 25 Grade-A office buildings.

It also has the potential to attract secondary investors, prioritising the development of the largest Korean community in Hanoi.



**Safety as a top priority**

Starlake Apartment features a three-tier security system with 24/7 security cameras. It also boasts the most modern fire safety system in the world, which includes an automatic fire suppression system that can control and extinguish fires without human intervention.



*\* The images in this brochure are not representation of fact.*





## Thoughtfully designed for luxury experiences

Comfort and luxury mean indulging in the best things the world has to offer. This is manifested in every unit at Starlake Apartment. Each apartment features ultra-luxurious fittings and furniture, using only the finest materials and thoughtfully designed rooms, to create the most splendid of living spaces. All blocks are arranged diagonally to create a wide area of view for every apartment. The flexible design creates soft, free, and exciting spaces that optimise the flow of natural light and wind.





Living rooms and bedrooms come with state-of-the-art furnishings by leading South Korean furniture companies. Bathrooms feature exquisite Korean-made taps and shower systems, ensuring that you feel as pampered in your own home as in a modern spa. The kitchens are fitted with the best Korean design styles, making cooking and entertaining guests more pleasurable and easier than ever before.



# Master Plan



A Apartment	B Apartment	C Apartment	D Apartment	E Apartment	F Apartment	G Apartment	H Apartment	K Apartment
Wall-center area: 101.80m <sup>2</sup> Net area: 91.25m <sup>2</sup>	Wall-center area: 108.12m <sup>2</sup> Net area: 96.24m <sup>2</sup>	Wall-center area: 110.00m <sup>2</sup> Net area: 98.08m <sup>2</sup>	Wall-center area: 113.94m <sup>2</sup> Net area: 100.95m <sup>2</sup>	Wall-center area: 124.97m <sup>2</sup> Net area: 109.82m <sup>2</sup>	Wall-center area: 127.96m <sup>2</sup> Net area: 112.06m <sup>2</sup>	Wall-center area: 128.75m <sup>2</sup> Net area: 113.21m <sup>2</sup>	Wall-center area: 142.99m <sup>2</sup> Net area: 125.41m <sup>2</sup>	Wall-center area: 177.41m <sup>2</sup> Net area: 154.54m <sup>2</sup>

# Layout Plan

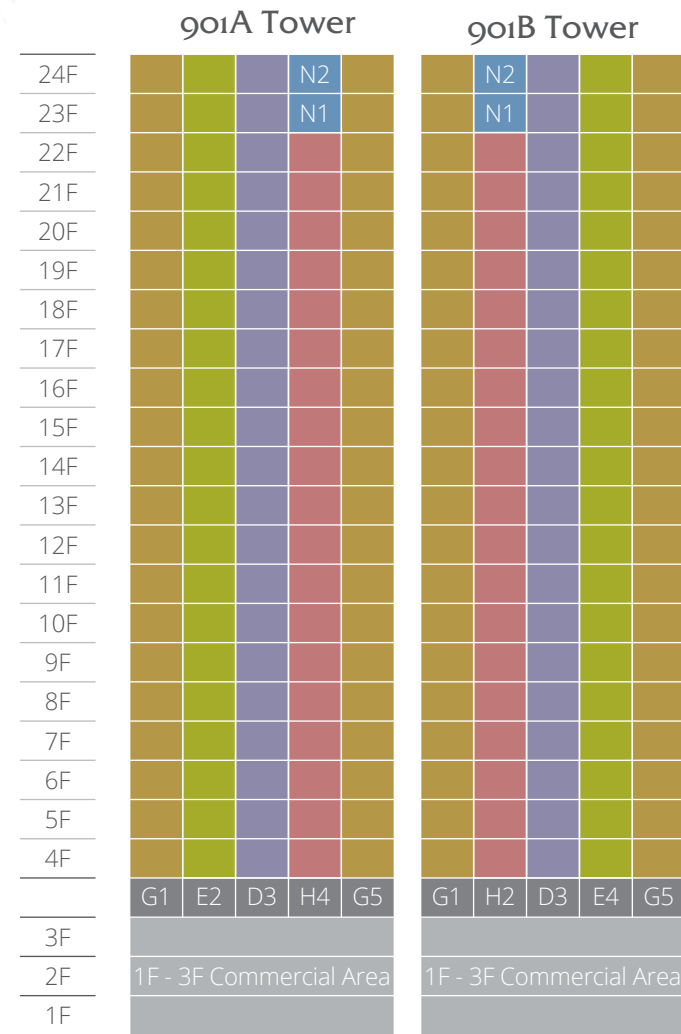

Type	D	E	G	H	N
m <sup>2</sup>	100.95	109.82	113.21	125.41	231.40

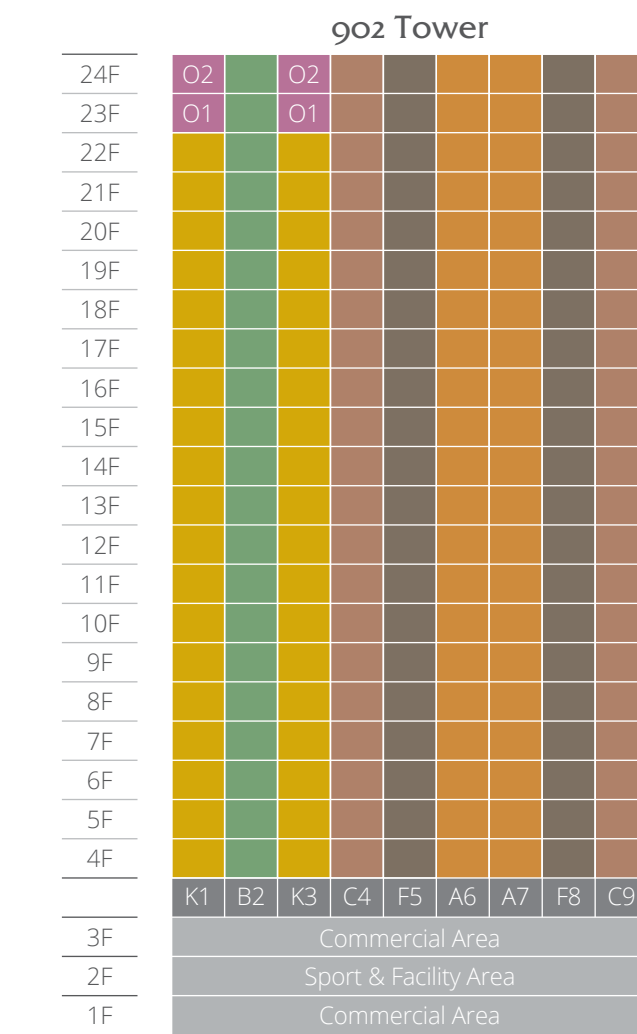

Type	A	B	C	F	K	O
m <sup>2</sup>	91.25	96.24	98.08	112.06	154.54	288.13

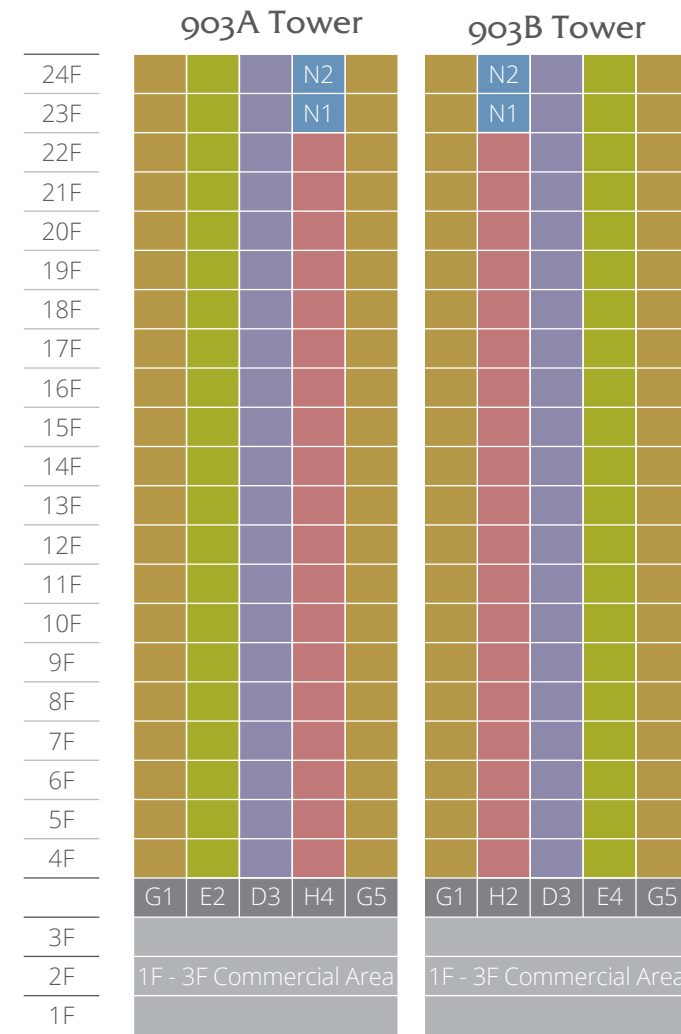

Type	D	E	G	H	N
m <sup>2</sup>	100.95	109.82	113.21	125.41	231.40

# Typical Unit Plan

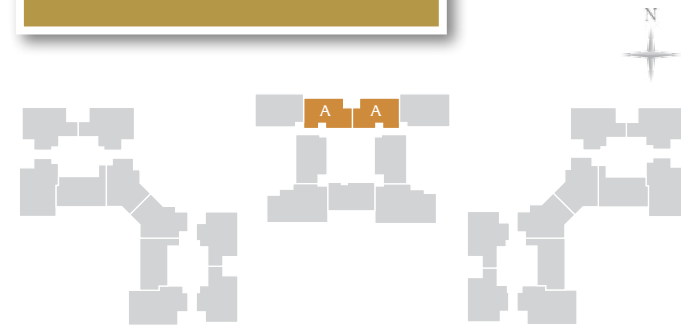

Type **A**  
91.25m<sup>2</sup>

Wall-center area: 101.80m<sup>2</sup>  
No. of Unit: 42  
No. of Bedroom: 2

- Type of use**
- Entrance: 3.91m<sup>2</sup>
  - Living Room + Kitchen + Dining Room: 43.16m<sup>2</sup>
  - Master Bedroom: 16.23m<sup>2</sup>
  - Bedroom 1: 11.54m<sup>2</sup>
  - Master Bathroom: 3.83m<sup>2</sup>
  - Family Bathroom: 3.41m<sup>2</sup>
  - Dress Room: 2.09m<sup>2</sup>
  - Loggia: 4.09m<sup>2</sup>
  - Utility: 2.99m<sup>2</sup>



Designed with the concept of Unit D (Sample apartment is available at Starlake Gallery House).

# Typical Unit Plan

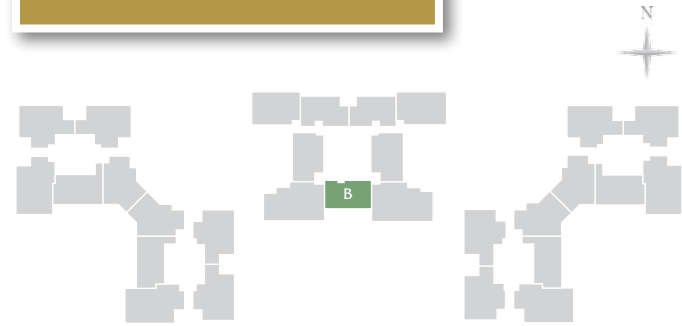

**Type B**  
96.24m<sup>2</sup>

Wall-center area: 108.12m<sup>2</sup>  
No. of Unit: 21  
No. of Bedroom: 2

**Type of use**

- Entrance: 3.68m<sup>2</sup>
- Living Room + Kitchen + Dining Room: 48.81m<sup>2</sup>
- Master Bedroom: 16.27m<sup>2</sup>
- Bedroom 1: 11.26m<sup>2</sup>
- Master Bathroom: 3.86m<sup>2</sup>
- Family Bathroom: 3.55m<sup>2</sup>
- Dress Room: 1.85m<sup>2</sup>
- Loggia: 3.85m<sup>2</sup>
- Utility: 3.11m<sup>2</sup>



Designed with the concept of Unit D (Sample apartment is available at Starlake Gallery House).

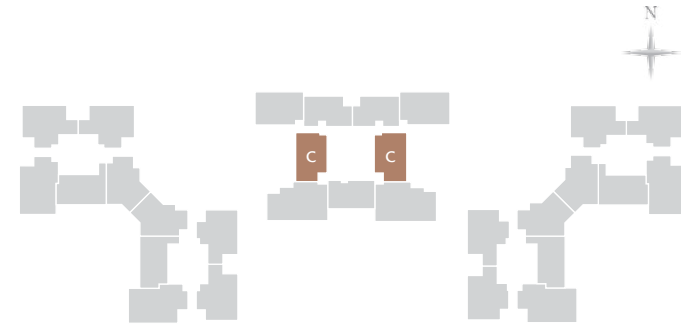

**Type C**  
98.08m<sup>2</sup>

Wall-center area: 110.00m<sup>2</sup>  
No. of Unit: 42  
No. of Bedroom: 2

**Type of use**

- Entrance: 6.76m<sup>2</sup>
- Living Room + Kitchen + Dining Room: 43.94m<sup>2</sup>
- Master Bedroom: 20.01m<sup>2</sup>
- Bedroom 1: 12.17m<sup>2</sup>
- Master Bathroom: 4.07m<sup>2</sup>
- Family Bathroom: 4.14m<sup>2</sup>
- Loggia: 3.23m<sup>2</sup>
- Utility: 3.76m<sup>2</sup>



Designed with the concept of Unit D (Sample apartment is available at Starlake Gallery House).

# Typical Unit Plan

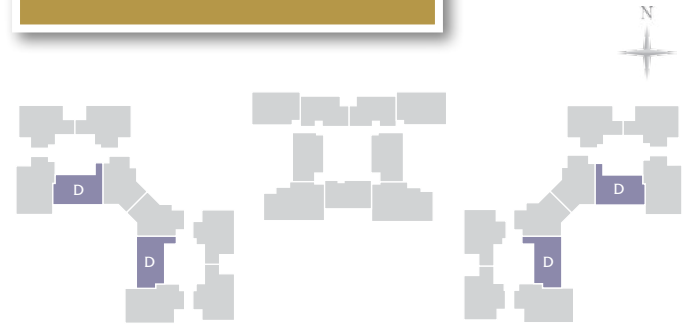

Type **D**  
100.95m<sup>2</sup>

Wall-center area: 113.94m<sup>2</sup>  
No. of Unit: 84  
No. of Bedroom: 2

### Type of use

Entrance: 4.62m<sup>2</sup>  
Living Room + Kitchen + Dining Room: 51.63m<sup>2</sup>  
Master Bedroom: 16.63m<sup>2</sup>  
Bedroom 1: 10.55m<sup>2</sup>  
Master Bathroom: 3.79m<sup>2</sup>  
Family Bathroom: 3.79m<sup>2</sup>  
Dress Room: 1.99m<sup>2</sup>  
Loggia: 4.26m<sup>2</sup>  
Utility: 3.69m<sup>2</sup>



Sample apartment is available at Starlake Gallery House.

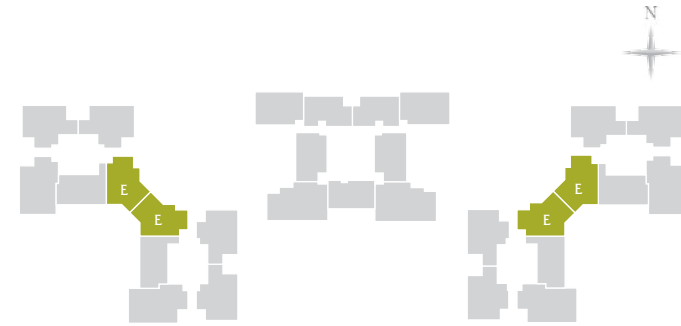

Type **E**  
109.82m<sup>2</sup>

Wall-center area: 124.97m<sup>2</sup>  
No. of Unit: 84  
No. of Bedroom: 3

### Type of use

Entrance: 5.13m<sup>2</sup>  
Living Room + Kitchen + Dining Room: 49.49m<sup>2</sup>  
Master Bedroom: 16.59m<sup>2</sup>  
Bedroom 1: 10.29m<sup>2</sup>  
Bedroom 2: 11.82m<sup>2</sup>  
Master Bathroom: 3.68m<sup>2</sup>  
Family Bathroom: 3.93m<sup>2</sup>  
Dress Room: 2.13m<sup>2</sup>  
Loggia: 3.68m<sup>2</sup>  
Utility: 3.08m<sup>2</sup>



Designed with the concept of Unit F (Sample apartment is available at Starlake Gallery House).

# Typical Unit Plan

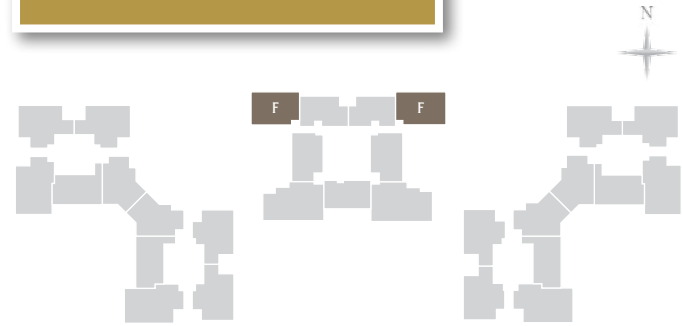

Type **F**  
**112.06m<sup>2</sup>**

Wall-center area: 127.96m<sup>2</sup>  
 No. of Unit: 42  
 No. of Bedroom: 3

### Type of use

- Entrance: 4.95m<sup>2</sup>
- Living Room + Kitchen + Dining Room: 48.86m<sup>2</sup>
- Master Bedroom: 18.55m<sup>2</sup>
- Bedroom 1: 10.68m<sup>2</sup>
- Bedroom 2: 10.58m<sup>2</sup>
- Master Bathroom: 4.99m<sup>2</sup>
- Family Bathroom: 3.97m<sup>2</sup>
- Dress Room: 2.17m<sup>2</sup>
- Loggia: 4.82m<sup>2</sup>
- Utility: 2.49m<sup>2</sup>



Sample apartment is available at Starlake Gallery House

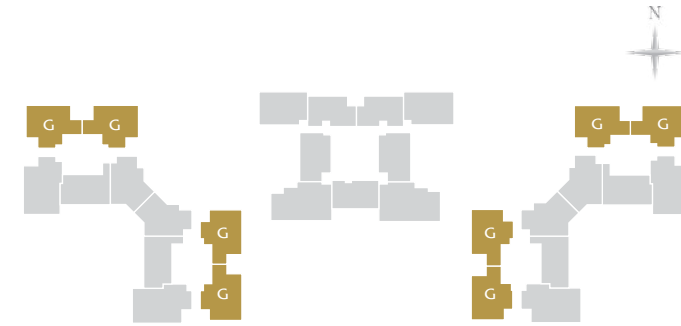

Type **G**  
**113.21m<sup>2</sup>**

Wall-center area: 128.75m<sup>2</sup>  
 No. of Unit: 168  
 No. of Bedroom: 3

### Type of use

- Entrance: 5.44m<sup>2</sup>
- Living Room + Kitchen + Dining Room: 47.92 m<sup>2</sup>
- Master Bedroom: 17.62m<sup>2</sup>
- Bedroom 1: 11.64m<sup>2</sup>
- Bedroom 2: 13.77m<sup>2</sup>
- Master Bathroom: 3.99m<sup>2</sup>
- Family Bathroom: 3.59m<sup>2</sup>
- Dress Room: 2.34m<sup>2</sup>
- Loggia: 4.26m<sup>2</sup>
- Utility: 2.64m<sup>2</sup>



Designed with the concept of Unit F (Sample apartment is available at Starlake Gallery House).

# Typical Unit Plan

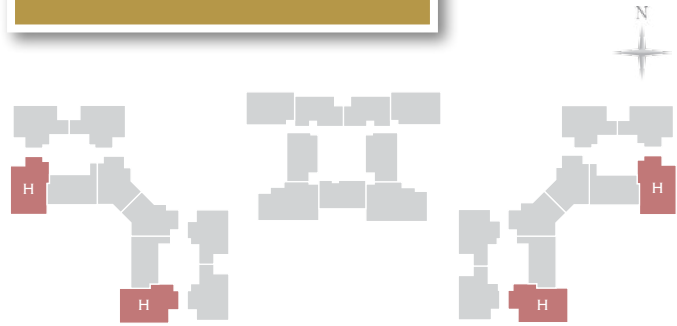

Type **H**  
125.41m<sup>2</sup>

Wall-center area: 142.99m<sup>2</sup>  
No. of Unit: 76  
No. of Bedroom: 3

### Type of use

- Entrance: 8.45m<sup>2</sup>
- Living Room + Kitchen + Dining Room: 56.15m<sup>2</sup>
- Master Bedroom: 18.72m<sup>2</sup>
- Bedroom 1: 10.89m<sup>2</sup>
- Bedroom 2: 12.47m<sup>2</sup>
- Master Bathroom: 4.48m<sup>2</sup>
- Family Bathroom: 3.39m<sup>2</sup>
- Dress Room: 3.27m<sup>2</sup>
- Loggia: 4.61m<sup>2</sup>
- Utility: 2.98m<sup>2</sup>



Designed with the concept of Unit K (Sample apartment is available at Starlake Gallery House).

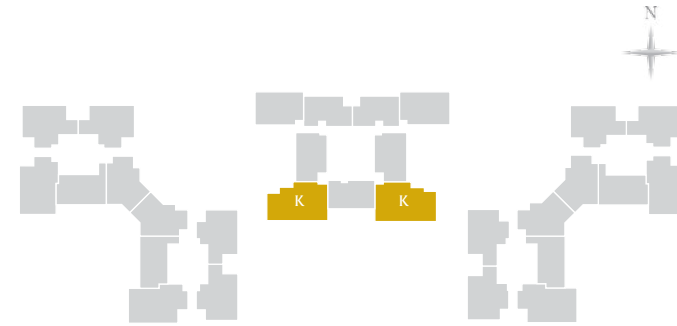

Type **K**  
154.54m<sup>2</sup>

Wall-center area: 177.41m<sup>2</sup>  
No. of Unit: 38  
No. of Bedroom: 4

### Type of use

- Entrance: 5.19m<sup>2</sup>
- Living Room + Kitchen + Dining Room: 66.08m<sup>2</sup>
- Master Bedroom: 18.34m<sup>2</sup>
- Bedroom 1: 16.38m<sup>2</sup>
- Bedroom 2: 12.16m<sup>2</sup>
- Bedroom 3: 10.49m<sup>2</sup>
- Storage: 3.60m<sup>2</sup>
- Master Bathroom: 4.36m<sup>2</sup>
- Family Bathroom: 4.08m<sup>2</sup>
- Bathroom 1: 3.35m<sup>2</sup>
- Dress Room: 2.96m<sup>2</sup>
- Loggia: 3.99m<sup>2</sup>
- Utility: 3.56m<sup>2</sup>



Sample apartment is available at Starlake Gallery House





# Typical Unit Plan

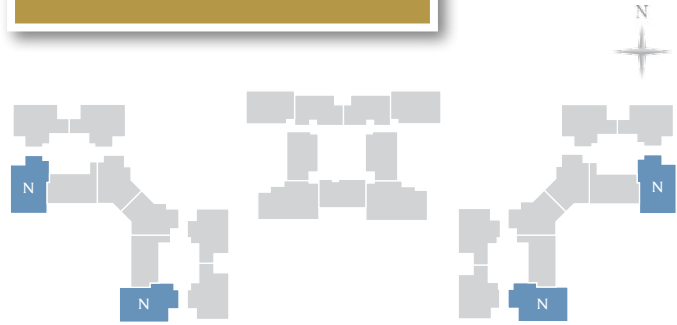

Type **N**  
231.40m<sup>2</sup>

N 23-24  
Wall-center area: 265.92m<sup>2</sup>  
No. of Unit: 4  
No. of Bedroom: 4

### Type of use

#### Level 23

- Entrance: 6.28m<sup>2</sup>
- Living Room + Kitchen + Dining Room: 63.11m<sup>2</sup>
- Master Bedroom: 16.44m<sup>2</sup>
- Bedroom 1: 11.83m<sup>2</sup>
- Storage: 7.26m<sup>2</sup>
- Master Bathroom: 6.36m<sup>2</sup>
- Family Bathroom: 3.39m<sup>2</sup>
- Dress Room 1: 3.85m<sup>2</sup>
- Loggia 1: 4.61m<sup>2</sup>
- Utility: 2.98m<sup>2</sup>



### Type of use

#### Level 24

- Bedroom 2: 29.97m<sup>2</sup>
- Bedroom 3: 15.95m<sup>2</sup>
- Bathroom 2: 4.94m<sup>2</sup>
- Bathroom 3: 3.18m<sup>2</sup>
- Dress Room 2: 2.23m<sup>2</sup>
- Loggia 2: 4.61m<sup>2</sup>
- Loggia 3: 8.17m<sup>2</sup>
- Family Room: 36.24m<sup>2</sup>



Designed with the concept of Unit K (Sample apartment is available at Starlake Gallery House).

# Typical Unit Plan

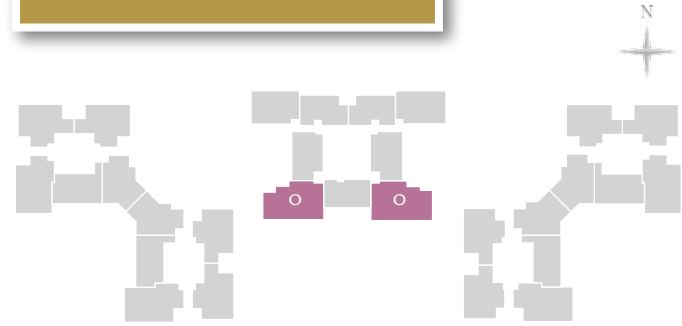

Type **O**  
**288.13m<sup>2</sup>**

**O 23-24**  
**Wall-center area: 334.42m<sup>2</sup>**  
**No. of Unit: 2**  
**No. of Bedroom: 6**

### Type of use

#### Level 23

- Entrance + Foyer: 8.15m<sup>2</sup>
- Living Room + Kitchen + Dining Room: 78,76m<sup>2</sup>
- Master Bedroom: 18.07m<sup>2</sup>
- Bedroom 1: 16.39m<sup>2</sup>
- Bedroom 2: 12.12m<sup>2</sup>
- Study Room 1: 6.73m<sup>2</sup>
- Master Bathroom: 4.90m<sup>2</sup>
- Bathroom 1: 3.35m<sup>2</sup>
- Family Bathroom 1: 4.08m<sup>2</sup>
- Storage: 3.59m<sup>2</sup>
- Dress Room 1: 3.72m<sup>2</sup>
- Loggia 1: 3.99m<sup>2</sup>
- Utility: 3.53m<sup>2</sup>



### Type of use

#### Level 24

- Family Room: 38.45m<sup>2</sup>
- Bedroom 3: 18.07m<sup>2</sup>
- Bedroom 4: 13.48m<sup>2</sup>
- Bedroom 5: 10.70m<sup>2</sup>
- Bathroom 3: 4.90m<sup>2</sup>
- Bathroom 4: 3.71m<sup>2</sup>
- Bathroom 5: 3.99m<sup>2</sup>
- Family Bathroom 2: 4.00m<sup>2</sup>
- Dress Room 2: 3.72m<sup>2</sup>
- Loggia 3: 3.99m<sup>2</sup>
- Loggia 4: 3.54m<sup>2</sup>
- Loggia 5: 12.20m<sup>2</sup>

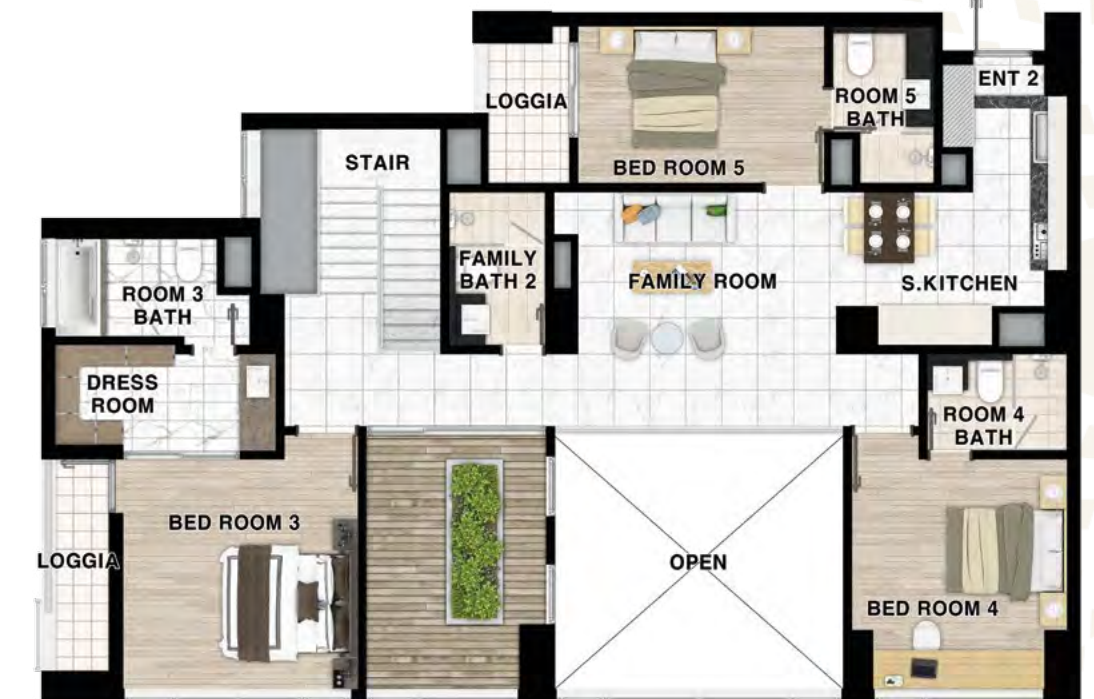

*Designed with the concept of Unit K (Sample apartment is available at Starlake Gallery House).*

## TAY HO TAY NEW TOWN URBAN AREA

**Address.** The central area of Tay Ho Tay new town  
Xuan Tao Ward, Bac Tu Liem District, Hanoi

**Hotline.** 1800 0003 / 0961 669 379

**Facebook.** [www.facebook.com/starlake.deawoenc](http://www.facebook.com/starlake.deawoenc)  
[www.starlake-hanoi.com](http://www.starlake-hanoi.com)

---

*Disclaimer: Visual presentation such as layout plans, illustrations, pictures, photographs, and drawings contained in this material are not representations of fact. Such materials are for guidance only and should not be relied upon as accurately describing any specific matter. All information, specifications, plans, and visual representations contained in the brochure are subject to change by the developer and shall not form part of the offer or contract. No part of this material shall constitute a representation or warranty.*