

Live larger
than life

Imagine a coveted address which
opens to a bold new world.
Empire City connects you to the world.

Live larger
than life

LINDEN RESIDENCES

Siteplan

The Thien
Central Lake

View of Icons Tower (BPT)
and retail center



View of Bitaco
and downtown
HCMC

Central
Board
Walk

Cho thuê TIC-xx.03

Size: 98.34 m2 | 87.76 m2 | 2 PN

Giá thuê: 2,000 USD/tháng

Empire City

Tòa	Tilia Residence - Tower TIC	Giá	2,000 USD
Tổng số tầng	30	Nội thất	Đầy đủ nội thất
Tầng	Cao	Phí quản lý	Không gồm phí
Mã căn	03	Hướng	
Phòng ngủ	2	View	
Phòng tắm	2	Mã	LS20220986

Ngày xuất:	31/05/2022
Ngày xem nhà:	31/05/2022
Ngày trống:	31/05/2022

TIỀN DỊCH VỤ (USD)



CARDI

Điện thoại: 097 366 3016

Email:
doankimthong98@gmail.com

PROPLINK

Số 32 đường Trần Lựu, phường
An Phú, thành phố Thủ Đức, TP
HCM, Việt Nam

Empire City, Thủ Thiêm, Quận 2, TP Hồ Chí Minh

- Thông tin chỉ mang tính chất tham khảo.

- Giá thuê có thể thay đổi do tỷ giá hối đoái thả nổi.

Typical Floor Plan

LINDEN RESIDENCES | TYPICAL FLOOR PLAN



MẶT BẰNG CĂN HỘ



Plans are not to scale and area is for reference only. Whilst every care has been taken to ensure accuracy in the preparation of the information contained herein, no warranties whatsoever are given or legal representatives is provided in respect thereof. Interested parties should rely on the formal sale and purchase documents. Visual representations including drawings, illustrations, photographs and all endorsements portray artistic impressions only and are not to be taken as representation of fact or law. The vendor reserves the rights to modify features, the units, plans or the development or any part thereof as may be approved or required by the relevant authorities.



9



Tilia Residences Type 1C-2BR-3

Unit Area: 98.79 sqm
Carport Area: 89.15 sqm

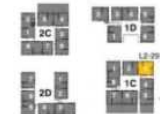

ẢNH CĂN HỘ & ẢNH MẶT BẰNG



Tilia Residences Type **1C-2BR-3**

Unit Area: 98.79 sqm
Carpet Area: 89.15 sqm

The floor plan shows a rectangular layout. At the top left is a bedroom (BR 1). At the top right is the Master Bedroom. The central area contains the Living Room and Dining Room. At the bottom is the Kitchen. A balcony is located on the right side of the unit. The unit is highlighted in yellow on a grid of other units.

Empire City

