



Rent

Size: 00 m2 | 00 m2 | 0 Bed

Rental price: 1,800 USD/month

## The Metropole Thu Thiem

Building	Lourve	Price	1,800 USD	Export date:	31 Dec 2021
No. of floor	0	Furniture	Semi-furnished	Visit Time:	31 Dec 2021
Floor		Management Fee	Exclude	Available Date:	31 Dec 2021
Unit No		Direction		<b>SERVICE LIST (USD)</b>	
Bedrooms		View			
Bathrooms		Code	LS20210816		



**JP HA**

Phone: 035 617 3495

Email: haworld@hanmail.net

**PROPLINK**

3rd Floor, No. 30 Nguyen Co  
Thach Str., Sala New City, Dist.  
2, HCM City

**HE ME** Thu Thiem New Urban Area, District 2, HCMC  
THU

- Information is for reference only.

The rent might vary due to the floating exchange rate.

# GENERAL LAYOUT OF PROJECT



**LEGEND:**

- 1. STREET SIDE DROP-OFF AREA
- 2. ENTRANCE/EXIT
- 3. WATER FEATURE WITH SCULPTURE
- 4. LOBBY WELCOME SPACE
- 5. VENTILATION SHAFT
- 6. BOULEVARD AT RIGHT HAND SIDE OF TOWER
- 7. BOULEVARD AT TOP SIDE OF TOWER
- 8. BOULEVARD AT BOTTOM SIDE OF TOWER
- 9. JOGGING TRACK
- 10. OUTDOOR EVENT LAWN
- 11. OUTDOOR FITNESS TRAIL
- 12. TAI CHI LAWN
- 13. SCULPTURAL GARDEN

# APARTMENT LAYOUT

## LEVEL 6,8,10 FLOOR PLAN

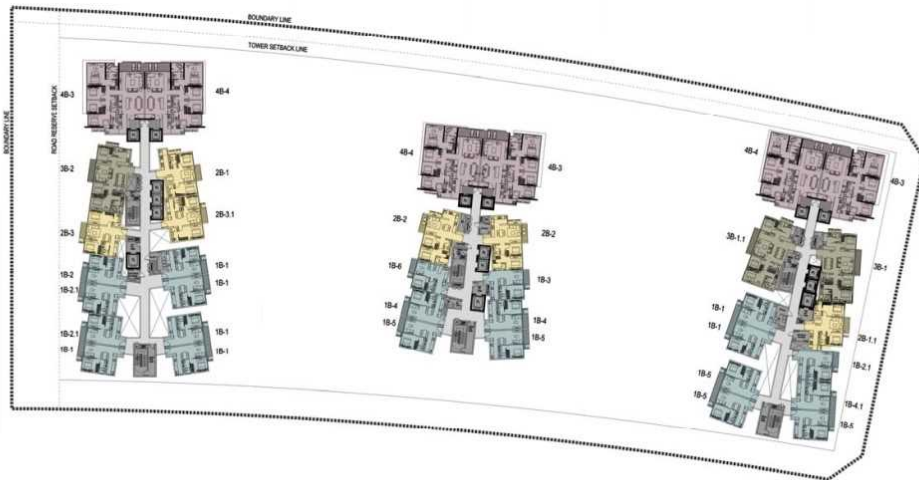

APPARTMENT IMAGE & LAYOUT

